

Features

- Chip LED (3.2 x 1.6 x 1.85)
- Super compact
- Reverse mountable



Package Outline Dimensions

(Unit:mm Tolerance:+/-0.1)

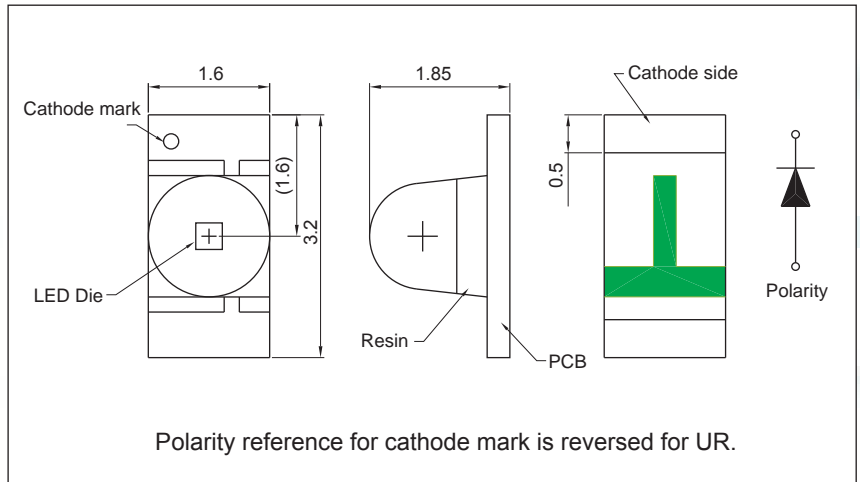

Directive Characteristics

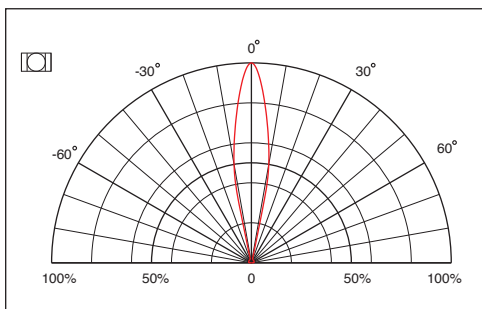
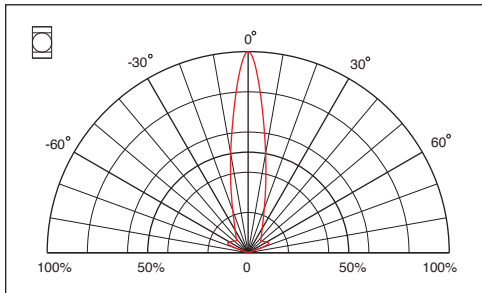

Recommended Soldering Pattern

Unit: mm

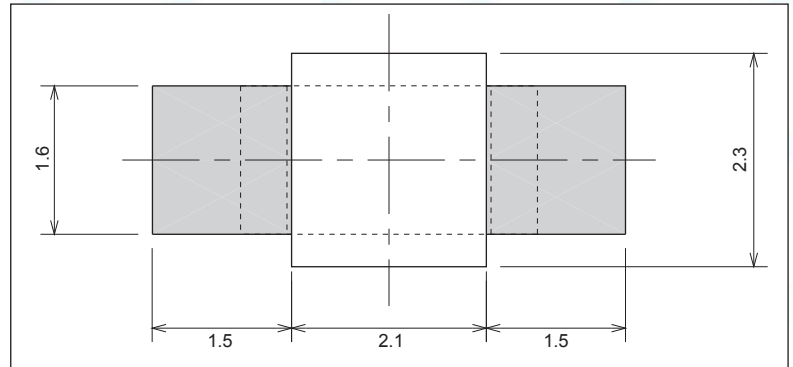

Absolute Maximum Ratings

(Ta=25°C)

Item	Symbol	GaP	GaAsP	AlGaAs	AllnGaP	InGaN	Unit
Power Dissipation	P _D	65	65	66	72	78	mW
DC Forward Current	I _F	25	25	30	30	20	mA
Pulsed Forward Current	I _{FP} *	100	100	100	100	80	mA
Reverse Voltage	V _R	5					V
Operating Temperature	T _{OP}	-30 to 80					°C
Storage Temperature	T _{ST}	-40 to 85					°C

* 0.1msec pulse, 10% duty cycle.

Electrical / Optical Characteristics

(Ta=25°C)

Part Number	Emitting color	Material	Forward Voltage(V _F)		Wavelength (nm) typ.			Luminous Intensity (mcd)*		I _F (mA)	Viewing Angle 2θ _{1/2}
			typ.	max.	D	P	Δ	min.	typ.		
HT-159YG	Yellow Green	GaP	2.2	2.6	573	568	30	45	100	20	20
HT-159Y	Yellow	GaAsP	2.1	2.6	590	589	35	45	100	20	20
HT-159D	Amber	GaAsP	2.1	2.6	608	610	35	45	100	20	20
HT-159SD	Super Bright Orange	GaAsP	2.1	2.6	629	642	35	45	100	20	20
HT-159UR	Super Bright Red	AlGaAs	1.8	2.2	643	660	20	45	100	20	20
HT-159UYG	Ultra Bright Yellow Green	AlInGaP	2.0	2.4	573	574	20	180	600	20	20
HT-159UY	Ultra Bright Yellow	AlInGaP	1.9	2.4	589	593	15	180	500	20	20
HT-159UD	Ultra Bright Amber	AlInGaP	1.9	2.4	605	609	17	180	700	20	20
HT-159USD	Ultra Bright Orange	AlInGaP	1.9	2.4	622	636	17	180	900	20	20
HT-159URO	Ultra Bright Red	AlInGaP	1.9	2.4	632	645	22	180	1000	20	20
HT-159NB	Blue	InGaN	3.3	3.9	470	468	40	500	850	20	20
HT-159NG	Green	InGaN	3.3	3.9	527	520	40	900	2000	20	20
HT-159TW	White	InGaN	3.3	3.9	x=0.29 y=0.31	-	-	1000	2500	20	20

*Per NIST standards

