



EVERLIGHT ELECTRONICS CO.,LTD.

Device Number : CDDF-512-019 REV: 2

0.56" Quadruple Digit Displays

PART NO. : ELF-512GWB/S354 ECN : Page: 2/5

Package Dimensions:

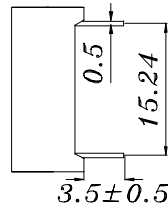
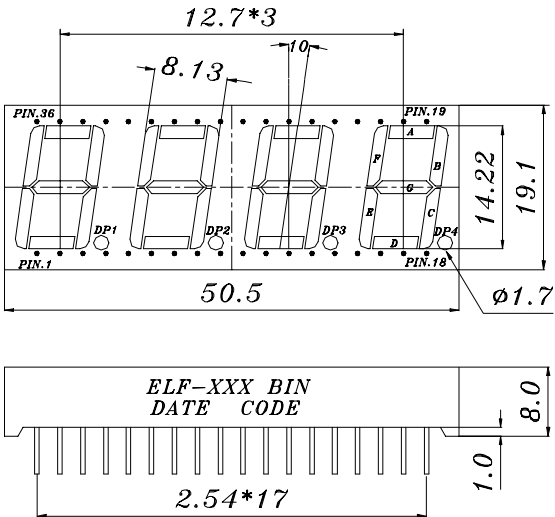

COMMON ANODE			
1 CATHODE 1E	19 CATHODE 4B		
2 CATHODE 1D	20 CATHODE 4A		
3 CATHODE 1C	21 CATHODE 4F		
4 NO CONNECT	22 COMMON ANODE D4		
5 CATHODE 2E	23 COMMON ANODE D3		
6 CATHODE 2D	24 CATHODE 3B		
7 CATHODE 2G	25 CATHODE 3A		
8 CATHODE 2C	26 CATHODE 3G		
9 NO CONNECT	27 CATHODE 3F		
10 CATHODE 3E	28 CATHODE 2B		
11 CATHODE 3D	29 CATHODE 2A		
12 CATHODE 3C	30 CATHODE 2F		
13 NO CONNECT	31 COMMON ANODE D2		
14 CATHODE 4E	32 COMMON ANODE D1		
15 CATHODE 4D	33 CATHODE 1B		
16 CATHODE 4G	34 CATHODE 1A		
17 CATHODE 4C	35 CATHODE 1G		
18 NO CONNECT	36 CATHODE 1F		

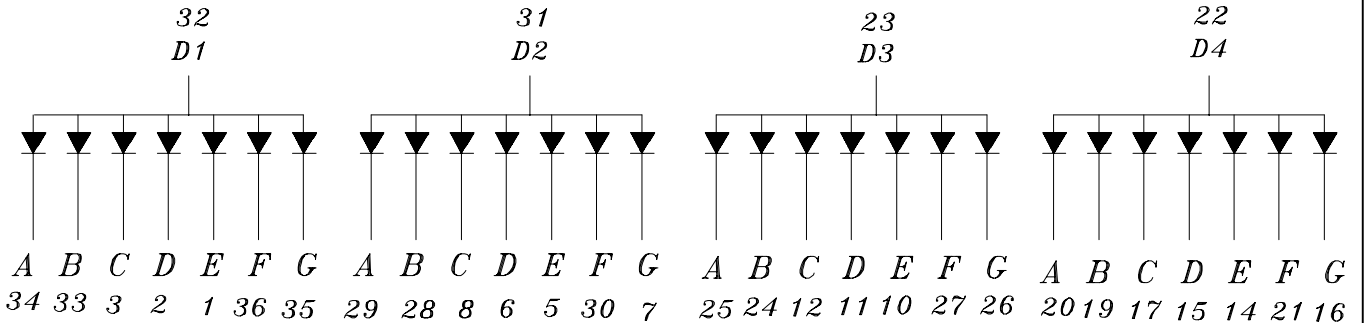

Notes:

1. All dimensions are in millimeters, tolerance is 0.25mm unless otherwise noted.
2. Above specification may be changed without notice.

Supplier will reserve authority on material change for above specification.



EVERLIGHT ELECTRONICS CO.,LTD.

Device Number : CDDF-512-019 REV: 2

0.56" Quadruple Digit Displays

PART NO. : ELF-512GWB/S354 ECN : Page: 3/5

■ Absolute maximum ratings at Ta = 25°C :

Parameter	Symbol	Rating	Unit
Reverse Voltage	VR	5	V
Forward Current	IF	30	mA
Operating Temperature	Topr	-40 to +85	°C
Storage Temperature	Tstg	-40 to +100	°C
Soldering Temperature	Tsol	260 ± 5	°C
Power Dissipation	Pd	100	mW
Peak Forward Current(Duty 1/10 @ 1KHZ)	IF(Peak)	160	mA

■ Electronic optical characteristics :

Parameter		Symbol	Min.	Typ.	Max.	Unit	Condition
Luminous Intensity	Per segment	Iv	1.4	2.8	----	mcd	IF=10mA
	Per decimal point		0.6	1.0	----		
Peak Wavelength		λp	----	565	----	nm	IF=20mA
Dominant Wavelength		λd	----	570	----	nm	IF=20mA
Spectrum Radiation Bandwidth		$\Delta \lambda$	----	30	----	nm	IF=20mA
Forward Voltage		VF	1.7	2.1	2.4	V	IF=20mA
Reverse Current		IR	----	----	10	μA	VR=5V



EVERLIGHT ELECTRONICS CO.,LTD.

Device Number : CDDF-512-019

REV: 2

0.56" Quadruple Digit Displays

PART NO. : ELF-512GWB/S354

ECN :

Page: 4/5

Typical Electro-Optical Characteristic Curves:

GHIP Material:Gap
Emitted Color:Yellow Green

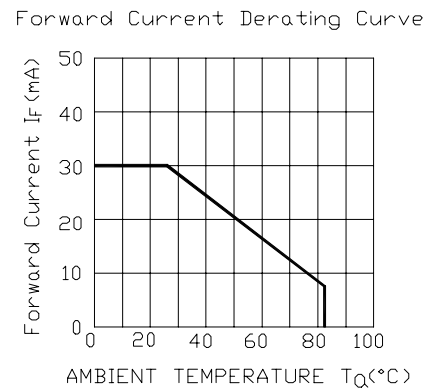
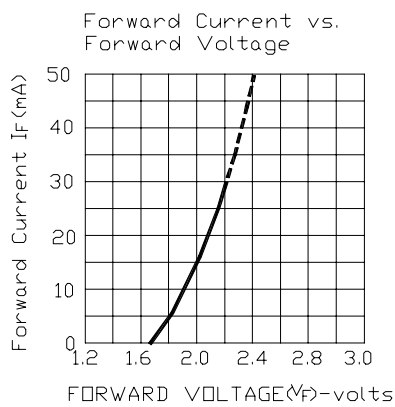
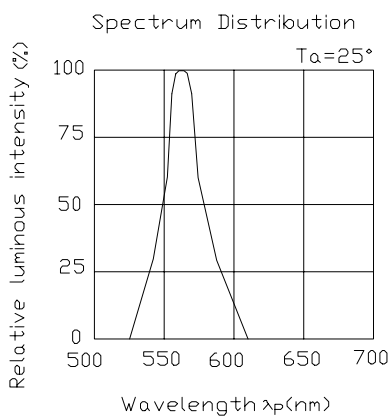



EVERLIGHT ELECTRONICS CO.,LTD.

Device Number : CDDF-512-019 REV: 2

0.56" Quadruple Digit Displays

PART NO. : ELF-512GWB/S354 ECN : Page: 5/5

■ Reliability test items and conditions:

NO	Item	Test Conditions	Test Hours/Cycle	Sample Size	Ac/Re
1	Solder Heat	TEMP : 260°C ± 5 °C	5 SEC	76 PCS	0/1
2	Temperature Cycle	H : +85°C 30min ∫ 5 min L : -55°C 30min	50 CYCLE	76 PCS	0/1
3	Thermal Shock	H : +100°C 5min ∫ 10 sec L : -10°C 5min	50 CYCLE	76 PCS	0/1
4	High Temperature Storage	TEMP : 100°C	1000 HRS	76 PCS	0/1
5	Low Temperature Storage	TEMP : -55°C	1000 HRS	76 PCS	0/1
6	DC Operating Life	IF = 10 mA	1000 HRS	76 PCS	0/1
7	High Temperature / High Humidity	85°C /85% RH	1000 HRS	76 PCS	0/1

--	--	--	--	--	--