

**Technical Data Sheet**

**Top LEDs**

**67-11-BHP-3HR2T1A6C-2T8-AM**

**Lead (Pb) Free Product - RoHS Compliant**



**Feature**

- P-LCC-2 package.
- Colored diffused resin.
- Wide viewing angle 120°.
- Inner reflector and white package.
- Brightness: 140 to 355 mcd at 10mA.
- Precondition: Bases on JEDEC J-STD 020D Level 2.
- Qualification according to AEC-Q101 rev C.
- Automotive reflow profile (IR reflow or wave soldering)

**Applications**

- Automotive backlighting or indicator: Interior and exterior lighting, Dashboard, switch, reading lamp, audio and video equipments...etc.
- Backlight: LCD, switches, symbol, mobile phone and illuminated advertising.
- Display for indoor and outdoor application.
- Ideal for coupling into light guides.
- Substitution of traditional light.
- Optical indicator.
- General applications.

**Device Selection Guide**

Chip	Emitted Color	Resin Color
Material		
InGaN	Ice Blue	Slightly Green Dotted

**Technical Data Sheet****Top LEDs****67-11-BHP-3HR2T1A6C-2T8-AM****Absolute Maximum Ratings (Ta=25 °C)**

Parameter	Symbol	Rating	Unit
Reverse Voltage	V <sub>R</sub>	5	V
Forward Current	I <sub>F</sub>	30	mA
Peak Forward Current (Duty 1/10 @1KHz)	I <sub>FP</sub>	100	mA
Power Dissipation	P <sub>d</sub>	120	mW
Junction Temperature	T <sub>j</sub>	125	
Operating Temperature	T <sub>opr</sub>	-40 ~ +100	
Storage Temperature	T <sub>stg</sub>	-40 ~ +110	
Thermal resistance	R <sub>th J-A</sub>	600	K/W
	R <sub>th J-S</sub>	400	K/W
ESD (Classification acc. AEC Q101)	ESD <sub>HBM</sub>	2000	V
	ESD <sub>MM</sub>	200	V
Soldering Temperature	T <sub>sol</sub>	Reflow Soldering : 260 Hand Soldering : 350	for 30 sec. for 3 sec.

**Technical Data Sheet****Top LEDs****67-11-BHP-3HR2T1A6C-2T8-AM****Electro-Optical Characteristics (Ta=25 )**

Parameter	Symbol	Min.	Typ.	Max.	Unit	Condition
Luminous Intensity	I <sub>V</sub>	140	---	355	mcd	I <sub>F</sub> =10mA
Viewing Angle	2θ <sub>1/2</sub>	---	120	---	deg	I <sub>F</sub> =10mA
Forward Voltage	V <sub>F</sub>	2.6	---	3.8	V	I <sub>F</sub> =10mA
Temperature coefficient of λ <sub>p</sub>	TC <sub>X</sub>	---	0.03	---	1/K	I <sub>F</sub> =10mA
Temperature coefficient of λ <sub>d</sub>	TC <sub>Y</sub>	---	0.02	---	1/K	I <sub>F</sub> =10mA
Temperature coefficient of VF	TC <sub>V</sub>	---	-2.8	---	mV/K	I <sub>F</sub> =10mA

Note:

1. Tolerance of Luminous Intensity : ±11%
2. Tolerance of Chromaticity Coordinates is : ±0.01
3. Tolerance of Forward Voltage : ±0.1V

**Technical Data Sheet**

**Top LEDs**

**67-11-BHP-3HR2T1A6C-2T8-AM**

**Bin Range of Luminous Intensity**

Bin Code	Min.	Max.	Unit	Condition
R2	140	180	mcd	I <sub>F</sub> =10mA
S1	180	224		
S2	224	280		
T1	280	355		

Notes : Tolerance of Luminous Intensity : ±11%

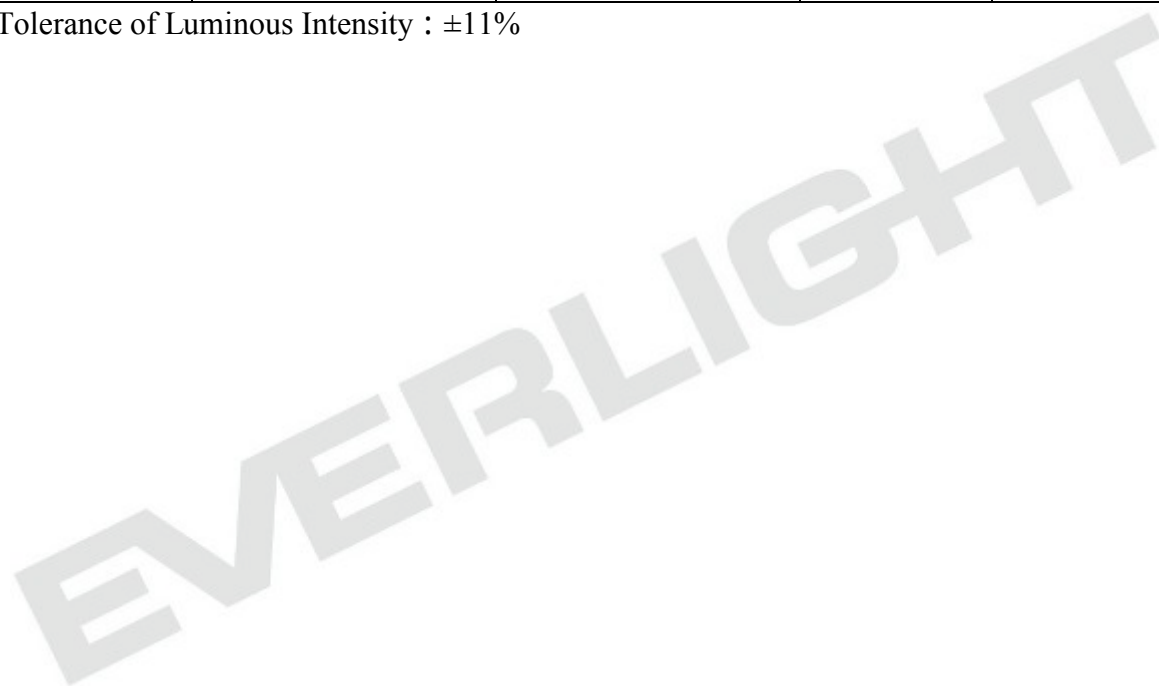

**Technical Data Sheet**

**Top LEDs**

**67-11-BHP-3HR2T1A6C-2T8-AM**

**Bin Range of Chromaticity Coordinates Specifications**

Group	Bin Code	CIE_x	CIE_y	Condition
3H	3L	0.1716	0.2454	10mA
		0.1775	0.2447	
		0.1735	0.2290	
		0.1677	0.2296	
	3K	0.1775	0.2447	
		0.1862	0.2437	
		0.1823	0.2280	
		0.1735	0.2290	
	4L	0.1756	0.2611	
		0.1814	0.2605	
		0.1775	0.2447	
		0.1716	0.2454	
	4K	0.1814	0.2605	
		0.1902	0.2595	
		0.1862	0.2437	
		0.1775	0.2447	

Note: : Tolerance of Chromaticity Coordinates:  $\pm 0.01$

### Technical Data Sheet

### Top LEDs

### 67-11-BHP-3HR2T1A6C-2T8-AM

#### The C.I.E. 1931 Chromaticity Diagram

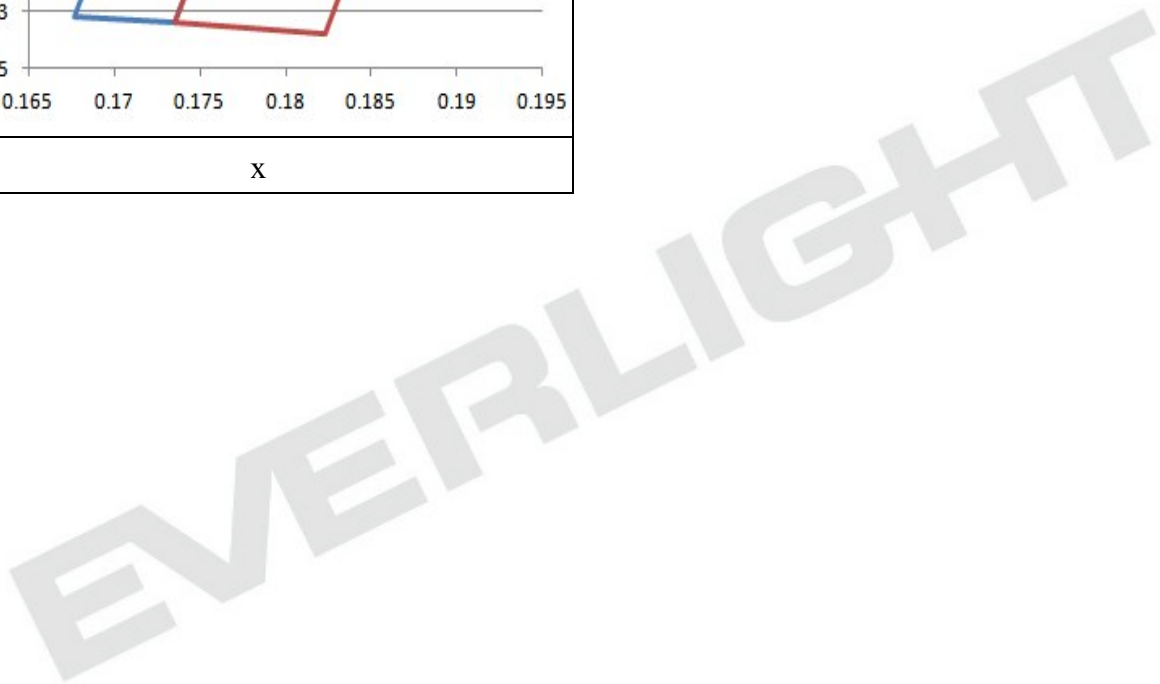
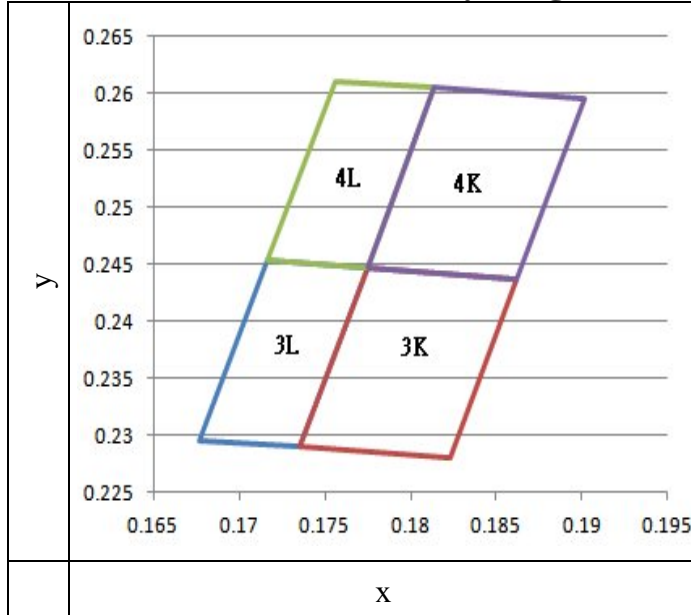

**Technical Data Sheet**

**Top LEDs**

**67-11-BHP-3HR2T1A6C-2T8-AM**

**Typical Electro-Optical Characteristics Curves**

**Typical Curve of Spectral Distribution**

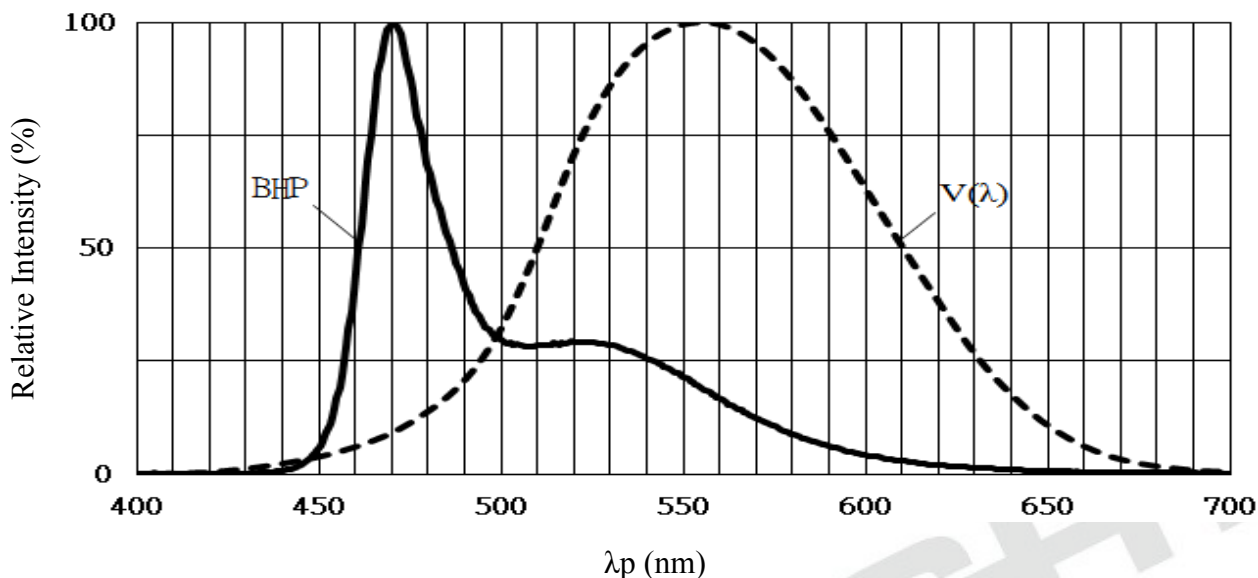

Note:  $V(\lambda)$ =Standard eye response curve

**Diagram Characteristics of Radiation**

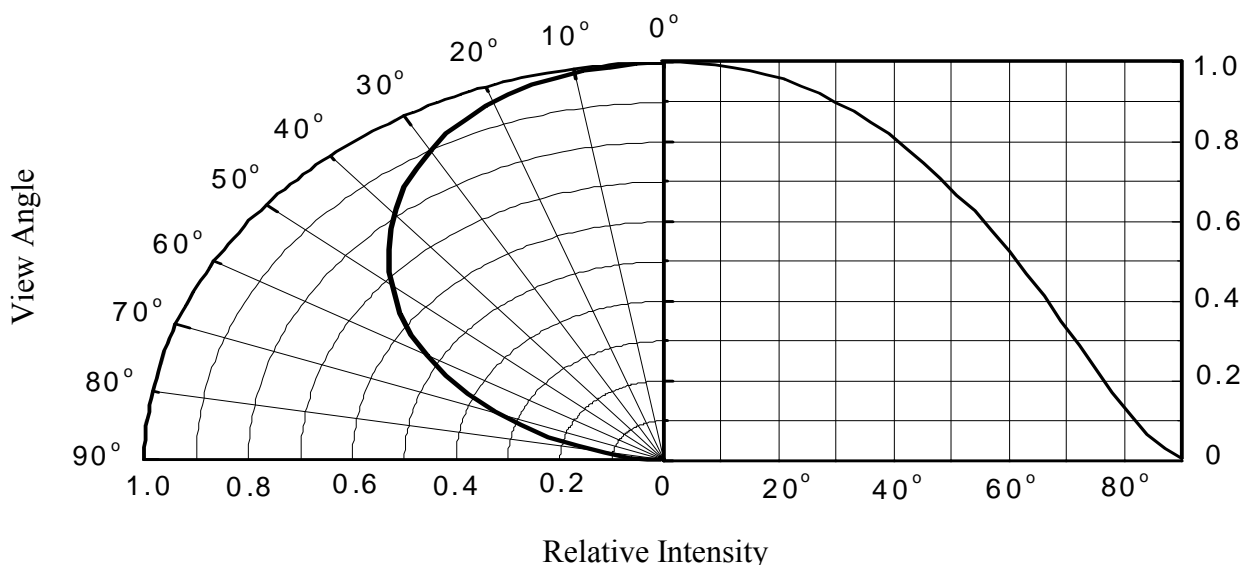

**Technical Data Sheet**

**Top LEDs**

**67-11-BHP-3HR2T1A6C-2T8-AM**

**Forward Current vs. Forward Voltage**  
( $T_a=25^\circ\text{C}$ )

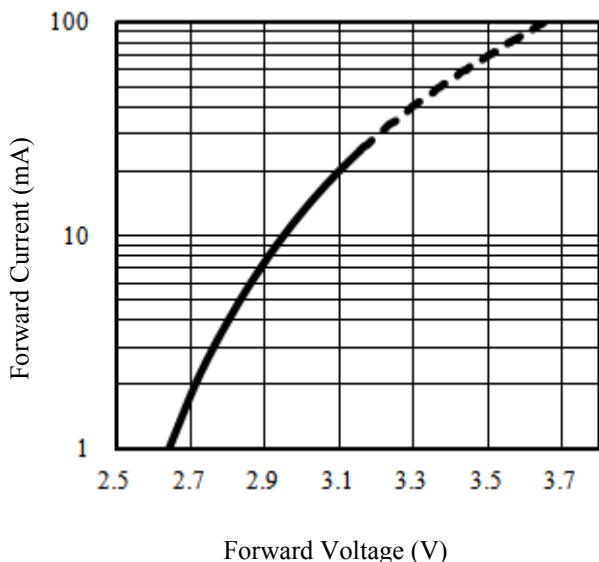

**Chromaticity Coordinates vs. Forward Current**  
( $T_a=25^\circ\text{C}$ )

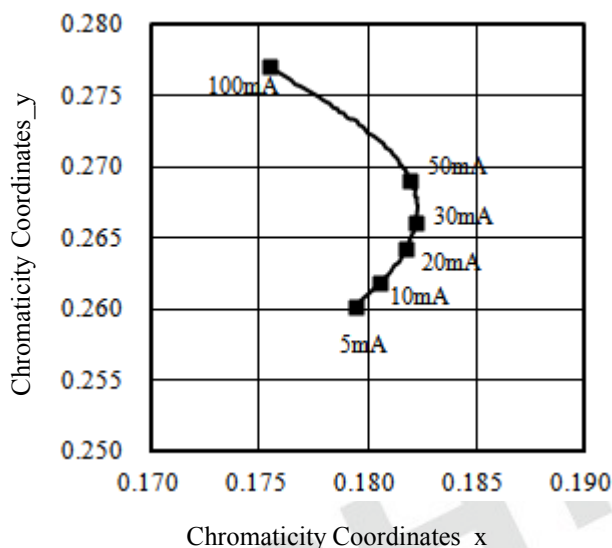

**Relative Luminous Intensity vs. Forward Current**  
( $T_a=25^\circ\text{C}$ )

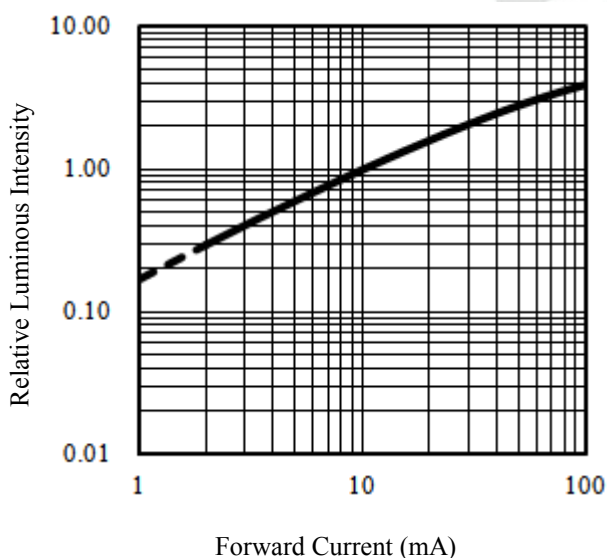

**Forward current vs. Ambient and Solder Temperature**

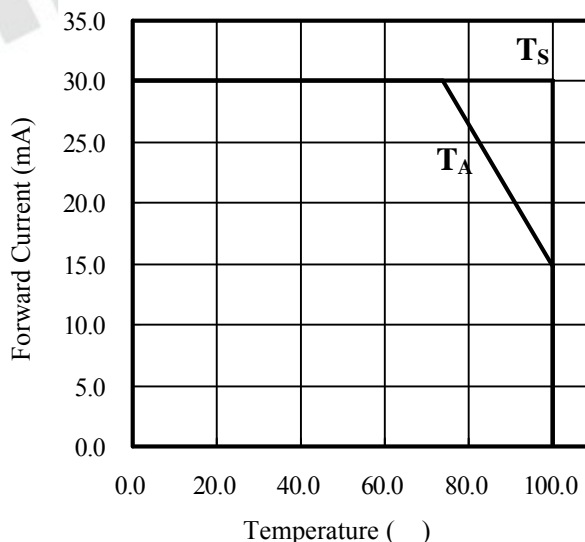



# Technical Data Sheet

## Top LEDs

### 67-11-BHP-3HR2T1A6C-2T8-AM

#### Package Dimension

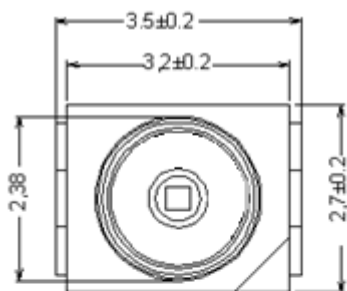

Chip position

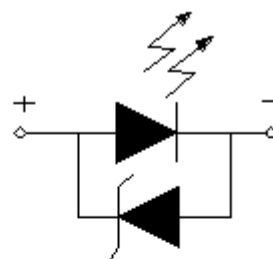

Polarity

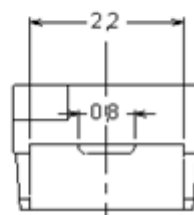
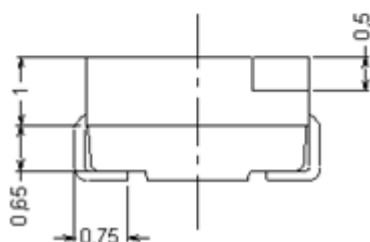

Note: Tolerances unless mentioned ±0.1mm. Unit = mm

**Technical Data Sheet**

**Top LEDs**

**67-11-BHP-3HR2T1A6C-2T8-AM**

Carrier Tape Dimensions: Loaded Quantity 2000 pcs Per Reel

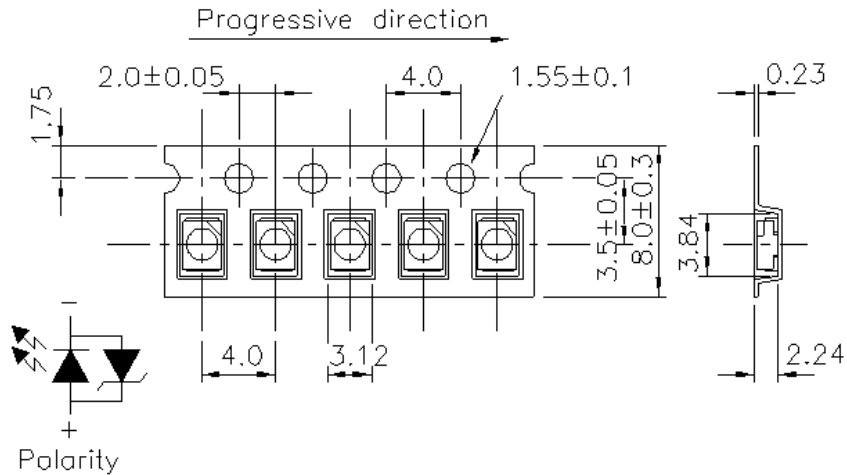

Note: Tolerances unless mentioned ±0.1mm. Unit = mm

**Label Explanation**

- CPN: Customer's Product Number
- P/N: Product Number
- QTY: Packing Quantity
- CAT: Luminous Intensity Rank
- HUE: Dom. Wavelength Rank
- REF: Forward Voltage Rank
- LOT No: Lot Number



Technical Data Sheet

Top LEDs

**67-11-BHP-3HR2T1A6C-2T8-AM**

Reel Dimensions

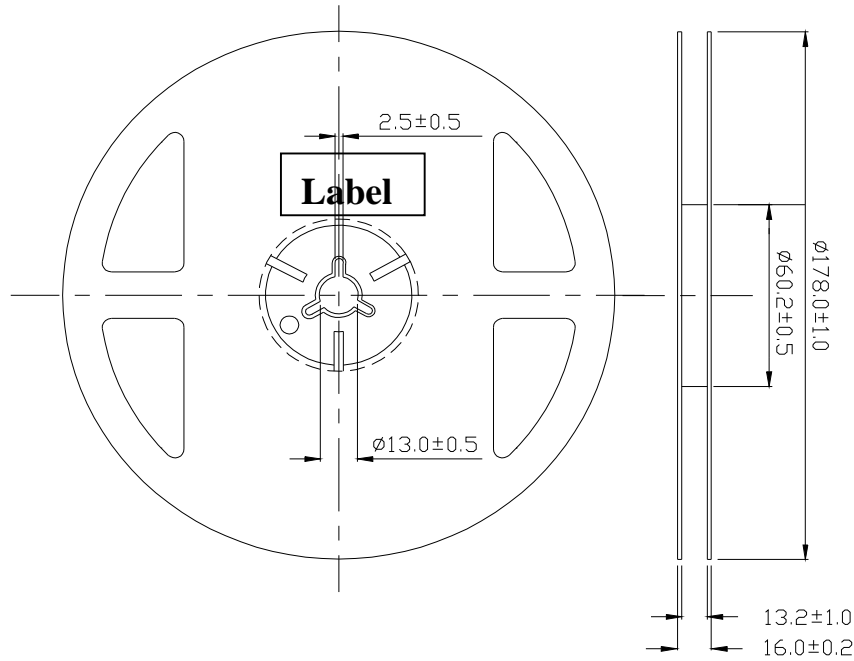

Note: Unit = mm

Moisture Resistant Packing Process

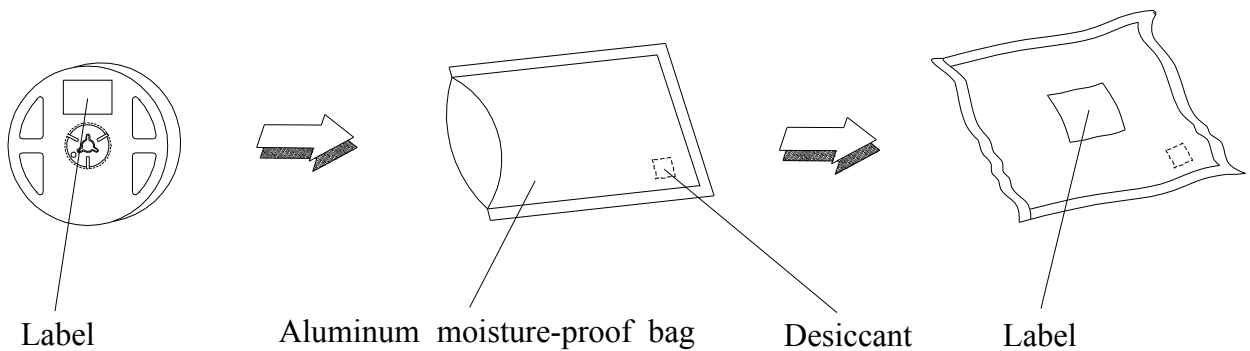

**Technical Data Sheet**

**Top LEDs**

**67-11-BHP-3HR2T1A6C-2T8-AM**

**Precautions for Use**

**1. Soldering Condition (Reference: IPC/JEDEC J-STD-020D)**

**a. IR reflow**

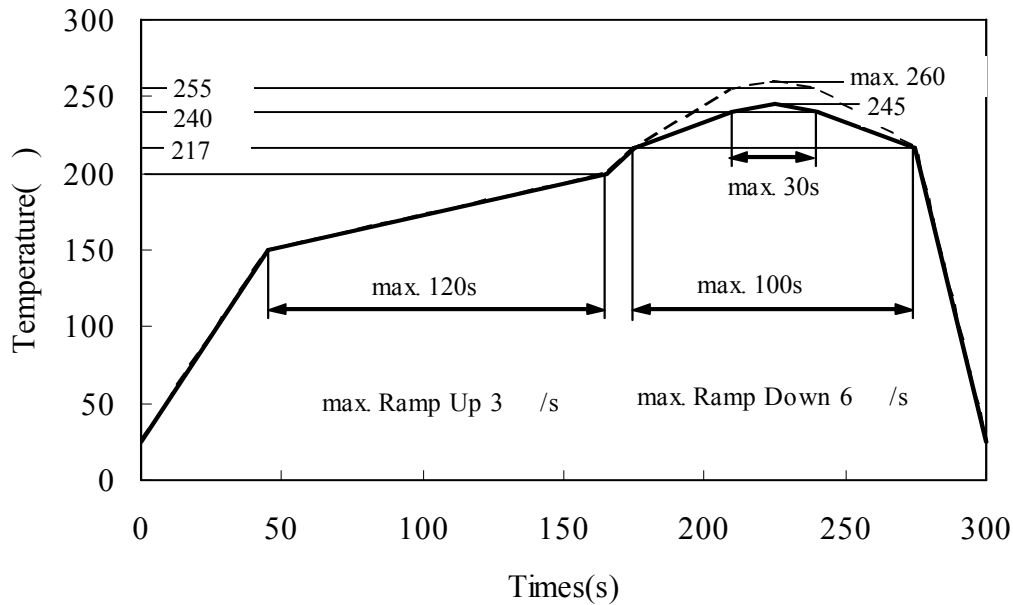

**b. Wave soldering reflow**

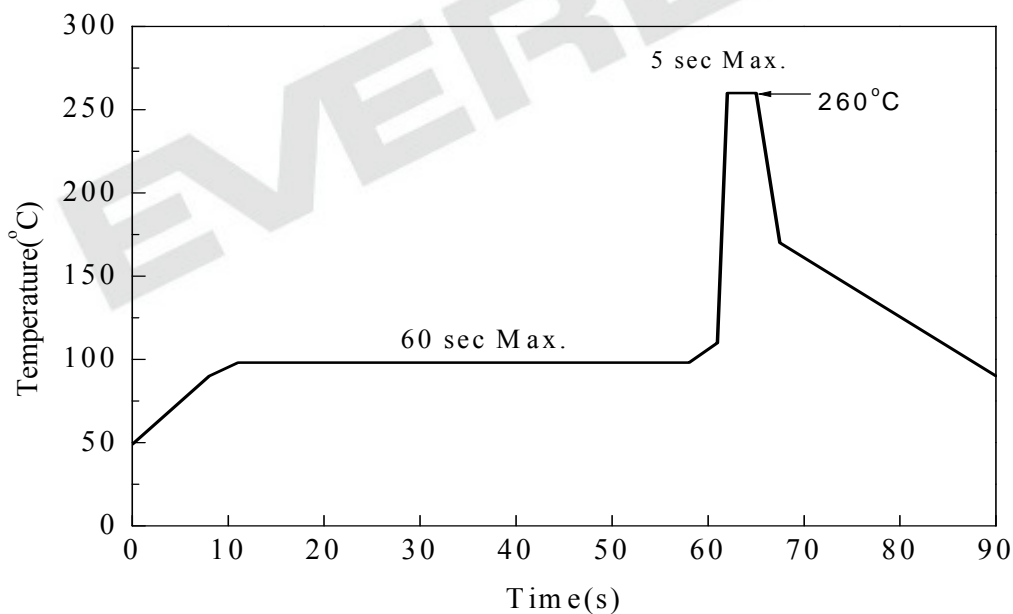

## Technical Data Sheet

### Top LEDs

#### 67-11-BHP-3HR2T1A6C-2T8-AM

(B) Recommend soldering pad

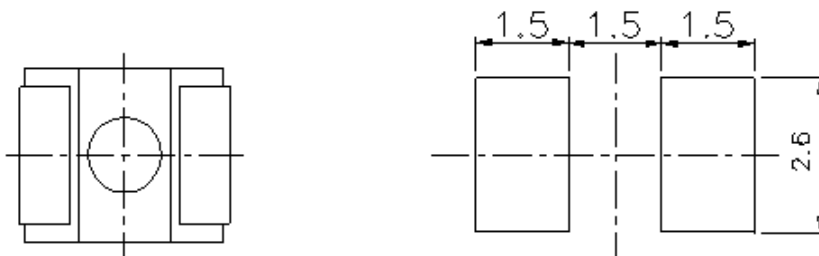

Note: Tolerances unless mentioned  $\pm 0.1$ mm. Unit = mm

#### 2. Current limiting

A resistor should be used to limit current spikes that can be caused by voltage fluctuations. Otherwise damage could occur.

#### 3. Storage

- 3.1 Moisture proof bag should only be opened immediately prior to usage.
- 3.2 Environment should be less than 30 °C and 60% RH when moisture proof bag is opened.
- 3.3 After opening the package MSL Conditions stated on page 1 of this spec should not be exceeded.
- 3.4 If the moisture sensitivity card indicates higher than acceptable moisture, the component should be baked at min. 60deg +/-5deg for 24 hours.

#### 4. Iron Soldering

Hand soldering is not recommended for regular production. These guidelines are for rework only. Soldering iron tip should contact each terminal no more than 3 sec at 350 °C, using soldering iron with nominal power less than 25W. Allow min. 2 sec. between soldering intervals.

#### 5. Usage

Do not exceed the values given in this specification.

#### Application Restrictions

High reliability applications such as military/aerospace, automotive safety/security systems, and medical equipment may require different product. If you have any concerns, please contact Everlight before using this product in your application. This specification guarantees the quality and performance of the product as an individual component. Do not use this product beyond the specification described in this document.

**Technical Data Sheet**

**Top LEDs**

**67-11-BHP-3HR2T1A6C-2T8-AM**

**Revision History:**

Rev.	Modified date	File modified contents
1	2012/02/10	New Spec

