



MODEL NO: 15-22SRUGC/TR8

Device Number : DSE-152-041 REV. 1.0

Chip LEDs with Bi-Color(Multi-Color)

ECN : _____ Page: 1/9

Features :

- PACKAGE IN 8mm TAPE ON 7" DIAMETER REEL .
- COMPATIBLE WITH AUTOMATIC PLACEMENT EQUIPMENT.
- COMPATIBLE WITH INFRARED AND VAPOR PHASE REFLOW SOLDER PROCESS.
- MULTI-COLOR TYPE.

Description :

- The 15-22 SMD Taping is much smaller than leaded components, thus enable smaller board size, higher packing density, reduced storage space and finally smaller equipment to be obtained.
- Besides, light Weight makes them ideal for miniature application, etc.

Applications :

- Automotive: backlighting in dashboard and switch.
- Telecommunication: indicator and backlighting in telephone and fax.
- Flat backlight for LCD, switch and symbol.
- General use.

Package Dimension :

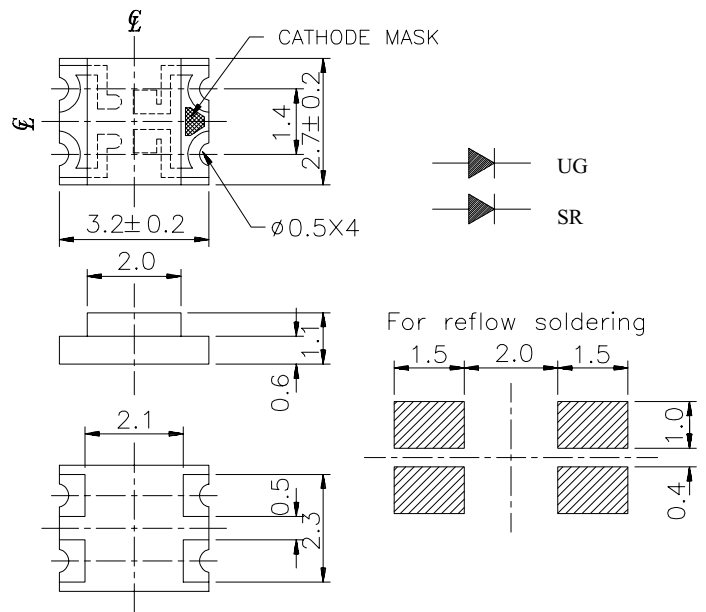

Notes :

Tolerances Unless Dimension ± 0.1mm

PART NO	CHIP		Lens Color
	Material	Emitted Color	
15-22SRUGC/TR8	SR:	GaAlAs Super Red	Water Clear
	UG:	GaP Super Green	

Office: NO. 25, Lane 76, Sec.3, Chung Yang Rd., Tucheng 236, Taipei, Taiwan, R.O.C.

TEL: 886-2-2267-2000, 2267-9936

FAX: 886-2-2267-6244, 2267-6189, 2267-6306

http://www.everlight.com



MODEL NO: 15-22SRUGC/TR8

Device Number : DSE-152-041 REV. 1.0

Chip LEDs with Bi-Color(Multi-Color)

ECN : _____ Page: 2/9

■ Package Dimension :

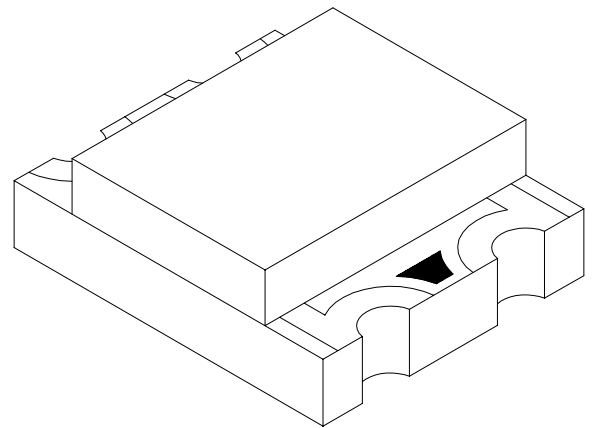
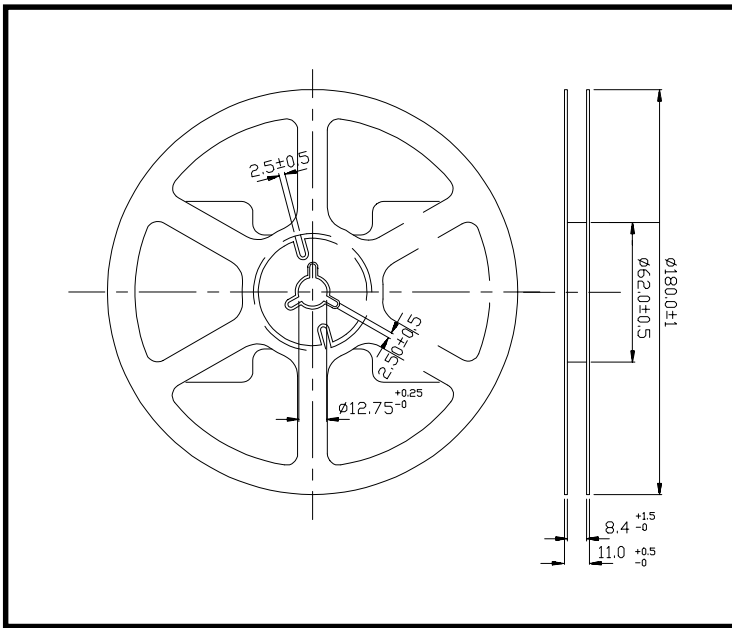

■ Loaded quantity per reel 2000 pcs/reel :

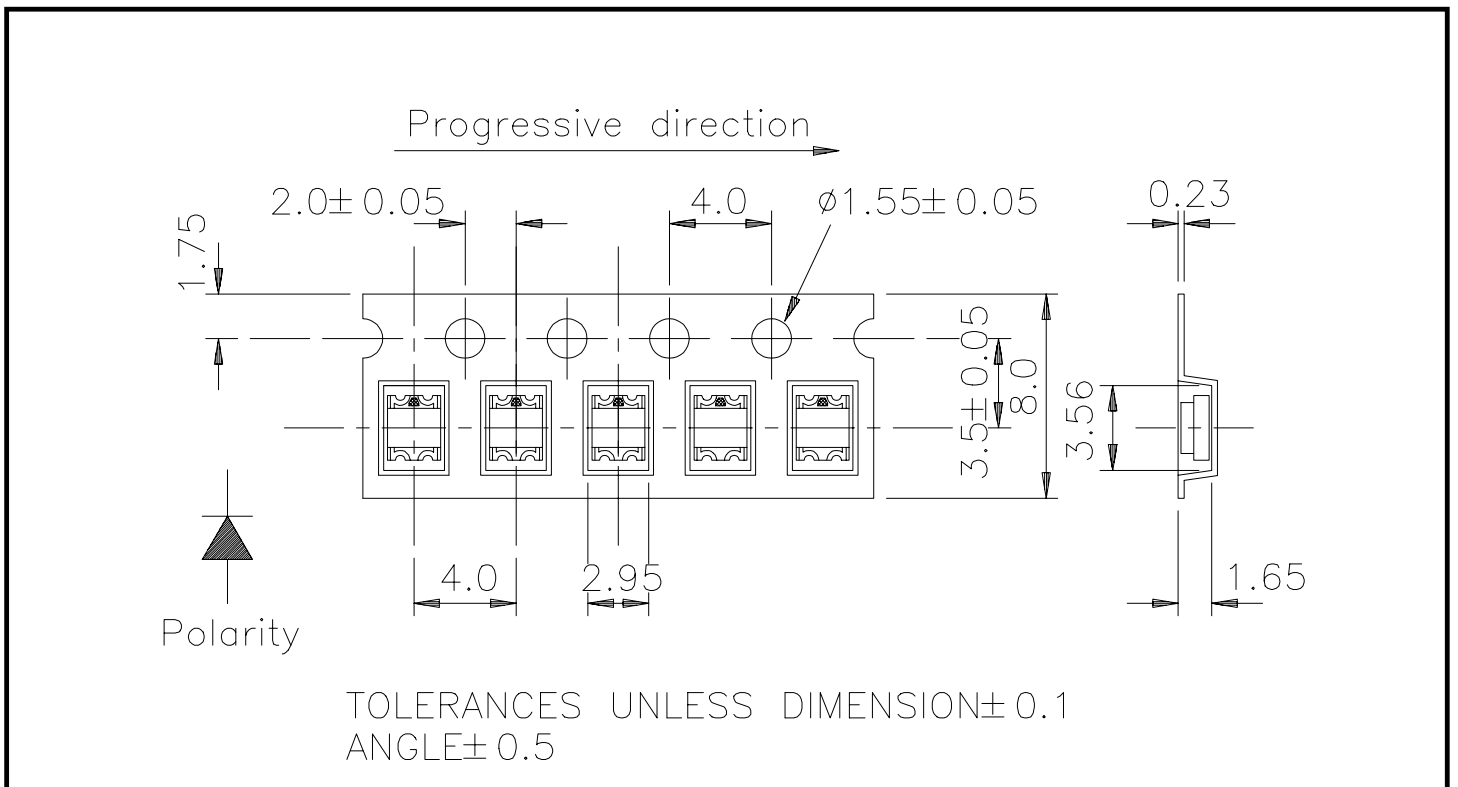



MODEL NO: 15-22SRUGC/TR8

Device Number : DSE-152-041 REV. 1.0

Chip LEDs with Bi-Color(Multi-Color)

ECN : Page: 3/9

Absolute Maximum Ratings at Ta = 25°C

Table with 4 columns: Parameter, Symbol, Rating, Unit. Rows include Reverse Voltage, Forward Current, Operating Temperature, Storage Temperature, Soldering Temperature, Power Dissipation, and Peak Forward Current.

Reliability Test Item And Condition

Table with 6 columns: NO, Item, Test Conditions, Test Hours/Cycle, Sample Size, Ac/Re. Rows describe various reliability tests like Solder Heat, Temperature Cycle, Thermal Shock, and DC Operating Life.



MODEL NO: 15-22SRUGC/TR8

Device Number : DSE-152-041 REV. 1.0

Chip LEDs with Bi-Color(Multi-Color)

ECN : Page: 4/9

Electronic Optical Characteristics :

Parameter	Symbol	Min.	Typ.	Max.	Unit	Condition
Luminous intensity	Iv SR: UG:	10	18		mcd	If=20mA
		8	15	-----		
Viewing Angle	2θ 1/2	-----	140	-----	deg	If=20mA
Peak Wavelength	λp SR: UG:		660		nm	If=20mA
		-----	570	-----		
Dominant Wavelength	λd SR: UG:		640		nm	If=20mA
		-----	573	-----		
Spectrum Radiation Bandwidth	Δλ SR: UG:		20		nm	If=20mA
		-----	30	-----		
Forward Voltage	Vf SR: UG:	1.5	2.0	2.4	V	If=20mA
		1.7	2.1	2.4		
Reverse Current	Ir	-----	-----	100	μA	Vr=4V

Specifications For Bin Grading

Bin Grading	Min.	Typ.	Max.	Unit
(SR)M	16	-----	32	mcd
(SR)N	25	-----	50	mcd
(UG)L	10	-----	20	mcd
(UG)M	16	-----	32	mcd



MODEL NO: 15-22SRUGC/TR8

Device Number : DSE-152-041 REV. 1.0

Chip LEDs with Bi-Color(Multi-Color)

ECN : _____ Page: 5/9

■ **Typical Electro-Optical Characteristic Curves**

SR

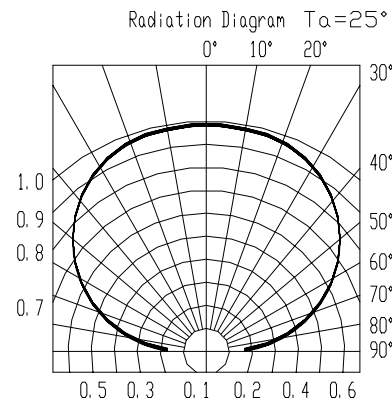
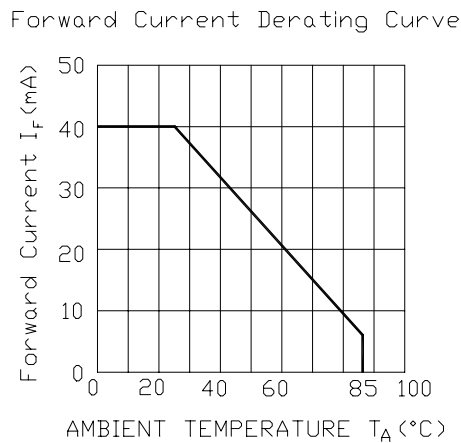
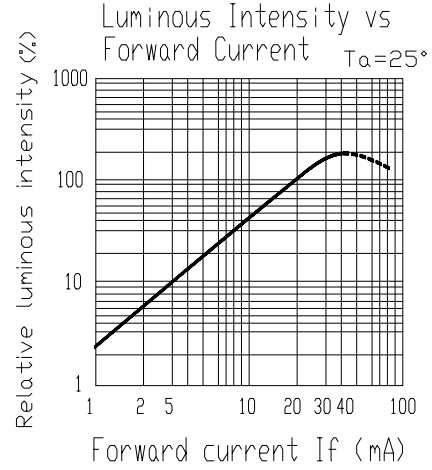
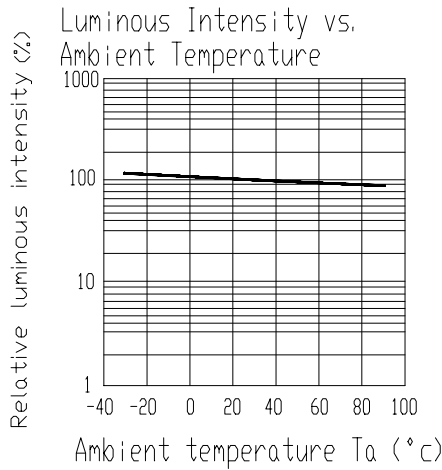
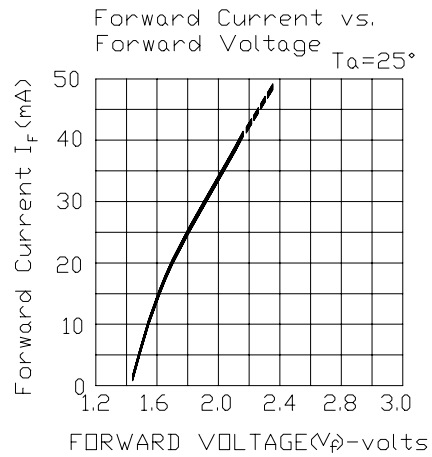
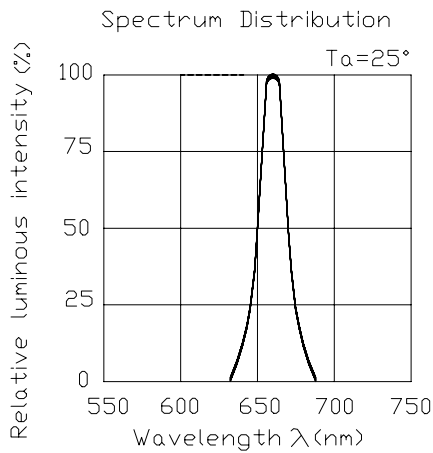



MODEL NO: 15-22SRUGC/TR8

Device Number : DSE-152-041 REV. 1.0

Chip LEDs with Bi-Color(Multi-Color)

ECN : _____ Page: 6/9

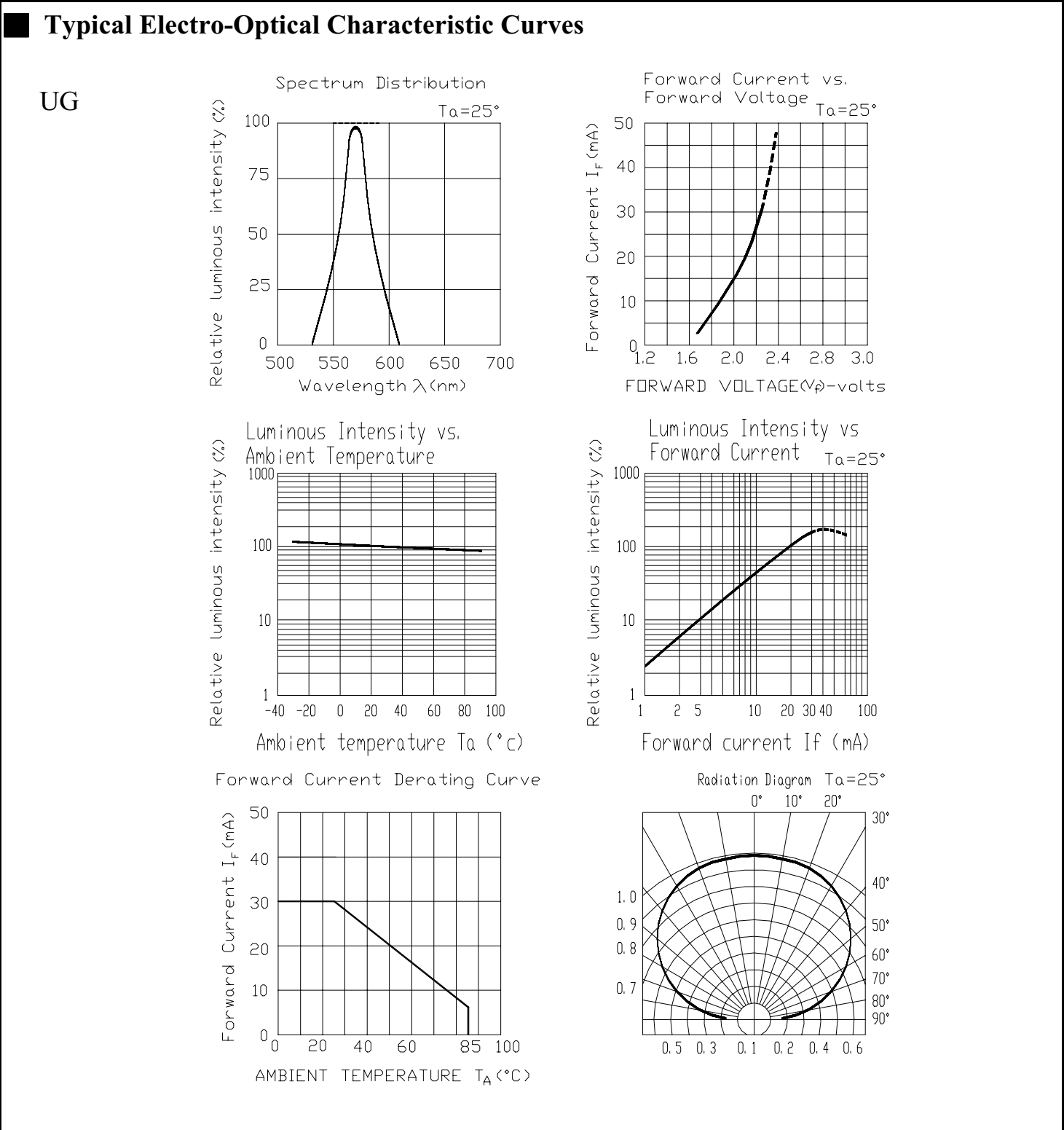



MODEL NO: 15-22SRUGC/TR8

Device Number : DSE-152-041 REV. 1.0

Chip LEDs with Bi-Color(Multi-Color)

ECN : Page: 7/9

■ **Test Circuit**

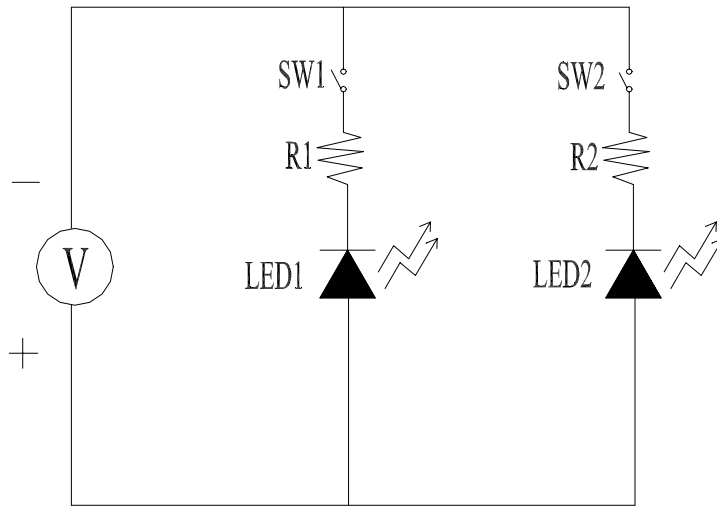

■ **Precautions For Use**

1. Over-current-proof

Customer must apply resistors for protection , otherwise slight voltage shift will cause big current change (Burn out will happen).

2. Storage time

- 2.1 The operation of temperature and R.H. are : $5^{\circ}\text{C} \sim 35^{\circ}\text{C}$, R.H.60%.
- 2.2 Once the package is opened , the products should be used within a week. Otherwise , they should be keep in a dampproof box with desiccants. Considering the tape life , we suggest our customers to use our products within a year(from production date).
- 2.3 If opened more than one week in an atmosphere $5^{\circ}\text{C} \sim 35^{\circ}\text{C}$, R.H.60% , they should be treated at $60^{\circ}\text{C} \pm 5^{\circ}\text{C}$ for 15hrs.
- 2.4 When you discover that the desiccant in the package has a pink color (normal=blue) , you should treat them in the same conditions as 2.3.



MODEL NO: 15-22SRUGC/TR8

Device Number : DSE-152-041 REV. 1.0

Chip LEDs with Bi-Color(Multi-Color)

ECN : Page: 9/9

■ Reflow Temp / Time :

